

Automatic welding machine Typ ROOFON

RoofOn ,R' Edge



RoofOn



SCOPE OF DELIVERY

Content of package:

- 1 Automatic welding machine type RoofOn
- 1 Guide handle
- 1 Starting plate
- 1 Operating manual

SICHERHEIT



Danger of life when opening the device as live components and connections are exposed. Unplug the device before opening it.



Danger of fire and explosion if the device is used incorrectly. Demonstrate the necessary caution when using the welding machine near combustible materials. Never use the device in inflammable areas.



!!! Danger of burns !!!

Do not touch the hot air device when it is still hot. Let the device cool down.



Connect the device to a **socket with protective earth conductor**. Any interruption of the protective earth conductor within or outside the device is dangerous! Only use extension cables with protective earth conductor and a minimum diameter of 2.5 mm².



The **voltage rating** stated on the nameplate must correspond to the mains voltage.

Maintain the maximal allowed impedance $Z_{max} = 0.301 \Omega + j 0.188 \Omega$.

Consult your local electricity supply board if necessary.



For personal protection, the device must be connected to a **residual current circuit breaker** before using it on construction sites.

Formatiert



Do not leave the device unobserved. Hot air radiation of the hot air device may ignite combustible materials. Heat may reach inflammable materials that are not visible or obvious.



Protect the device from damp and wet!

WARRANTY AND LIABILITY

Warranty and liability apply from the date of purchase (documented by the invoice/delivery note) according to the currently valid general terms of business of BAK GmbH. BAK refuses to honour any warranty for devices which are not in their original condition. BAK devices may never be reconfigured and/or modified.

BAK reserves the right to deny any responsibility if this is ignored. No liability can be assumed by BAK for incorrect installation and/or use as well as natural wear and tear of components (e. g. heating elements).

Note:

This operating manual must be available to the installation and operating personnel at all times. Read these operating instructions carefully before installing and using the device.

Copyright:

This document must not be disclosed to third parties without the explicit written approval of BAK GmbH. Any forms of reproduction or copying and electronic storage are prohibited.

INTENDED USE

This device is an automatic welding machine for overlap/tape welding of weld tarpaulin and the production of plastic film and coated fabrics.

Weld shape overlap: Welding lines with a width of 20, 30 or 40 mm are produced depending on the applicable configuration.

Weld shape tape: Tapes with a width of 40 or 50 mm are produced depending on the applicable configuration.

Weld shape protection against vandalism: A tape with integrated steel cable is welded on.

Weld shape measuring tape: A profiled tape is welded on for sealing an overlap welding line.

DESCRIPTION OF FUNCTIONS

Heating system:

The hot air temperature is steplessly adjustable and electronically controlled. According to the material thickness, the nozzle position can be adjusted steplessly.

Welding pressure:

The welding pressure can be changed by adding or reducing weight.

Drive:

The drive is steplessly adjustable and electronically controlled. The control system is designed in a way that the set speed remains constant, independent of the load.

WARNING

- If the power supply cable gets damaged, it has to be replaced by the manufacturer, its customer service or by a qualified person in order to avoid danger.
- The device must not be used by personnel (including children) with limited physical, sensory or mental capabilities or lack of experience and/or knowledge, except when supervised by a person who is responsible for their safety or when advised how to use the device by that person.
- Children must be supervised in order to ensure that they do not play with the device.
- Because of the enormous fire danger, the operating personnel must be specially briefed and regularly instructed.
- Fire can occur if the device is not used carefully.
- Do not leave the device unobserved while it is in operation.
- Demonstrate the necessary caution when operating the device near inflammable materials. Do not operate on the same surface for longer periods of time.
- A fire extinguisher must always be within reach in the work area.
- The device must not be used in explosive atmospheres.
- Heat may reach inflammable materials that are not readily visible.
- There is a very significant risk of fire when the machine stops because of any disturbance and the hot air device is still running (max. temperature of the air flow 650 °C). Therefore, special attention should be placed on the subsurface and the material to be processed.
- The welding machine must not be used on inflammable surfaces (e. g. wooden roofs and floors made of wood)
- The device bears the protection mark IP20 and must therefore be protected from damp and rain.
- When using the device on roofs and tables, it could fall down due to its automatic drive system. In order to avoid a fall, necessary precautions must be taken.
- The welding machine can be operated up to a maximum incline or slope of 30°.
- Warning: danger of poisoning! While processing thermoplastics or similar material, gases occur which can be aggressive or poisonous. Avoid inhaling fumes even if they seem to be harmless. Make sure the workplace is well ventilated or wear respiratory protection.

SAFETY SYMBOLS AND STANDARDS

Existing risks are pointed out with the following warning symbols:

Risk of crushing



Risk of burns



The operator is responsible for the compliance with safety related standards.
Before the machine is commissioned, the operating personnel must be instructed with respect to these standards.

OPERATIONAL SAFETY

The welding machine is manufactured in accordance with the recognised rules of technology.
The latest safety standards have been observed to eliminate work related risks to the life and health of the operating personnel when the machine is used in accordance with its intended use.

DANGER ZONE

The main danger zone of the welding machine is the nozzle which can heat up to temperatures of 650 °C. It is recommended to wear heat protective gloves.
There is a risk of crushing when swivelling the nozzle.



!!! Danger of burns in the working area !!!

OVERLAP WELDING MACHINE BASIC ADJUSTMENT

Basic adjustment:

Perform adjustments only in cold condition (Danger of burns!).

Nozzle adjustment:

- Loosen the screws on the device frame in order to change the configuration of the nozzle.
- Please refer to the following images for recommended adjustments:

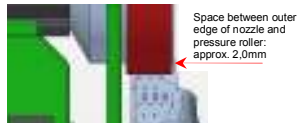
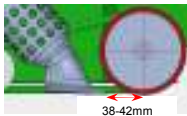

Guide roller adjustment:



Space	for	welding line with
10mm	→	20mm
20mm	→	30mm
30mm	→	40mm

- Bring the welding machine into the right welding position.

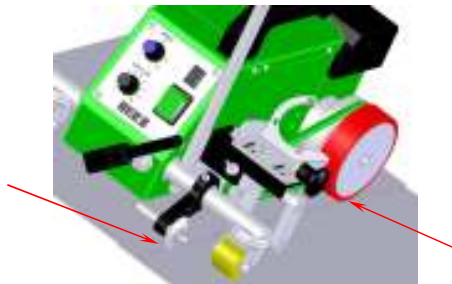

Outside edge of the overlap, outside edge of the pressure roller and outside edge of the guide roller must form a line (see image).

WELDING PARAMETERS

Caution: Before any welding operation, a test weld should be performed so as to determine the welding parameters.

Welding temperature:

The welding temperature is adjusted with a potentiometer or control unit. Do not start welding before the set temperature has been reached.

Welding speed:

The welding speed is adjusted using a potentiometer or control unit. The drive starts automatically when the welding machine is swivelled in. The welding speed is adjusted with the potentiometer or control unit depending on the plastic film, geomembrane liner or weather conditions.

Welding pressure:

The welding pressure is directly applied onto the pressure roller by the weight of the machine.

WELDING

Operating conditions:

- Maintain the maximum allowed network impedance ($Z_{\max} = 0.301 \Omega + j 0.188 \Omega$) and consult your local electricity supply board if necessary.
- Check the configuration of the nozzle.
- The mains connection must conform to ICE 60364 as well as to national standards.
- Connect the device to the grid. The voltage rating must correspond to the specifications on the nameplate.
- When using extension cords, a minimum diameter of the cable must be observed. Cable length up to 25 m, diameter 2.5 mm² (for automatic welding machines with 120 V, we recommend a diameter of 4.0 mm²).

WELDING

Welding procedure:

- Adjust the welding parameters.
- The welding temperature must have been reached.
- **Weld shape overlap:**
 - Position the welding machine on the overlapping geomembrane liners or plastic films.
 - Align the guide roller to the overlap.
 - Lower the hot air system and slide the nozzle between the overlapping geomembrane liners or plastic films. The device will start automatically.
 - Guide the welding machine along the overlap. Always observe the position of the guide roller.
- **Weld shape tape/protection against vandalism/measuring tape:**
 - Position the welding machine on the geomembrane liner or plastic film.
 - Position the guide roller at the joint or marking.
 - Lower the hot air system and slide the nozzle between geomembrane liner or plastic film and tape. The device will start automatically.
 - Guide the welding machine along the joint or marking. Always observe the position of the guide roller.
- After welding, slide out the nozzle and raise it.
- Turn off the heating with the respective switch to cool down the nozzle.
- Switch off the device with the main switch.

ASSISTANCE AND SUPPORT

The **HERZ** group and its authorised service centres offer free support and assistance in the area of applications technology.
Our specialists will be pleased to help you.

ACCESSORIES

Available accessories:

Additional weight (5230177), handle (5230077), running wheel relocation / edge roller (5230183).
The automatic welding machines can either be supplied with the accessories directly assembled or the assembly can be easily carried out by the operator himself.
Optimum results will be achieved when **HERZ** accessories and spare parts are used.
Please refer to our brochures for additional information.

ASSEMBLY



!!! ATTENTION !!!
ALWAYS unplug the device before working on it !!!

1.0. Changing the heating element (only when the device has cooled down)

- 1.1. Swivel out and lock the hot air system
- 1.2. Loosen four screws at the flange of the nozzle
- 1.3. Pull off the nozzle
- 1.4. Pull off the mica tube (careful, fragile)
- 1.5. Remove the gasket
- 1.6. Pull off the defective heating element
- 1.7. Insert the new heating element - observe marking, voltage and power rating
- 1.8. Slide on the mica tube
- 1.9. Slide on the gasket and position the boreholes
- 1.10. Slide on the nozzle and fix with 4 screws
- 1.11. Readjust the nozzle as described under **basic adjustments** on page 4 - 6.

INSTALLATION INSTRUCTIONS 8.0 and 9.0 ARE ENCLOSED WITH THE ACCESSORIES !!!

MAINTENANCE

- Clean the welding nozzle with a wire brush (5201330).
- Check power cable and plug for electrical and mechanical damage.

SERVICE AND REPAIR

The welding machine should be checked by an authorised service centre approx. every 1000 operating hours.

Repairs have to be carried out exclusively by [HERZ](#) authorised service centres.

SHIPPING

For repairs, please return the device appropriately packed for transport to your next [HERZ](#) service centre.

!!! SHIPPING MUST BE PAID!!!

Technical modifications reserved. In case of doubt, consultation with [HERZ](#) is required. Images and drawings may deviate from the original. Changes reserved.

TRANSPORT - HANDLING - STORAGE

Transport:

The welding machine is packed appropriately and must be protected from moisture.

Handling:

The shipment must be checked for completeness and transport damage. In the event of transport damage, the defect must be confirmed in writing at the time of the delivery by the carrier. The seller must be promptly informed in writing!

Storage:

In the case of temporary storage, the welding machine should be kept packed and must be protected from moisture. In the case of damage resulting from improper storage, no warranty claim will be honoured.

DISPOSAL



Power tools, accessories and packaging should be sorted for environmentally friendly recycling.

Do not dispose of power tools together with household waste!

Only EU countries: According to the European Directive 2002/96/EC on waste electrical and electronic equipment and its incorporation into national law, power tools that are no longer operational must be separately collected and sent to be environmentally friendly recycled.

TECHNICAL DATA

Technical Data		RoofOn [*proximate]	
Voltage	V	120	230
Frequency	Hz	50 / 60	
Power consumption	W	2'700	3'400
Max. power input	A	22,5	15,0
Temperature	°C	20 – 600	
Drive	m/min	Standard 0,6 – 12,0 / Digital 0,0 – 12,0	
Max. air flow (20 °C)	l/min	500	
Noise level (EN ISO 11203)	dB(A)	64	
Dimensions	mm (L x W x H)	460 x 330 x 850	
Weight with 5 m cable	kg	ca. 14,5[*26,0]	
Protection class		IP20	
Conformity symbol			
Protection type I			

Other voltages on request.

DEVICE DESCRIPTION

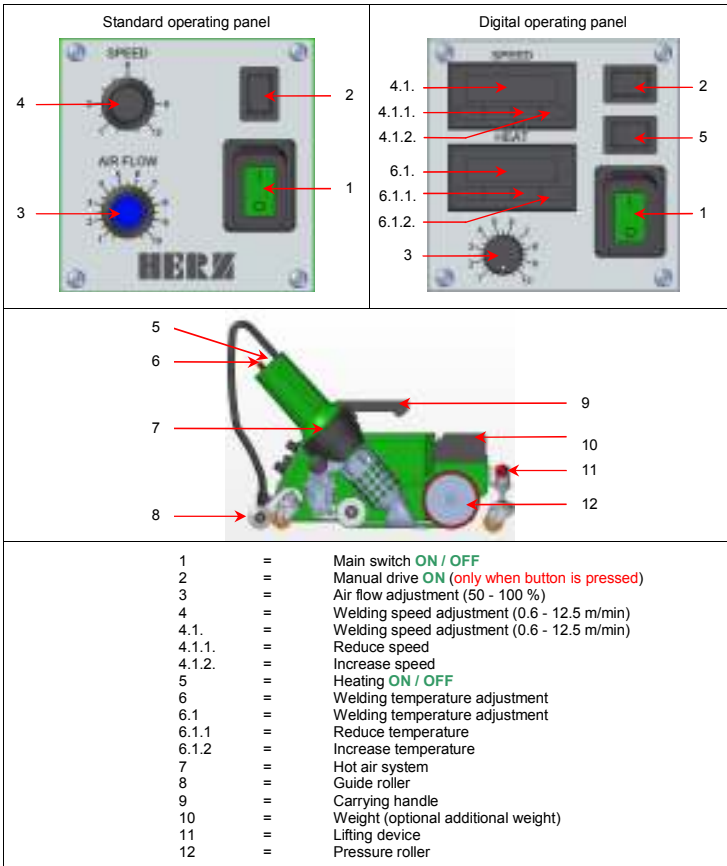

ASSEMBLY INSTRUCTIONS FOR ACCESSORY NO. 8: ADDITIONAL WEIGHT

Content: Art. no. 5230177
Additional weight
Screw M6x 50mm
Assembly instructions

Required tools: Allen keys SW3/5

8.0. Assembly instructions for additional weight:

8.1. Switch off the device, unplug it and let it cool down if necessary.



8.2. Screw out the M6x10 threaded bolt (Allen SW3).



8.3. Add additional weight and align it with the threaded bore hole of the weight below.



8.4. Screw on the M6x50 screw (Allen SW5) and fasten.

8.5. In order to remove an additional weight, perform the steps in reverse order.

ASSEMBLY INSTRUCTIONS FOR ACCESSORY NO. 9: RUNNING WHEEL RELOCATION / EDGE ROLLER

Content: Art. no. 5230183

Running wheel relocation / edge roller complete
Assembly instructions

Required tools: Allen key SW6

9.0. Running wheel relocation / edge roller assembly:

- 9.1. Switch off device
- 9.2. Unplug device
- 9.3. Lay device on its side

9.4. Remove Allen screw of the guide handle (SW6)



9.5. Assemble the guide handle **AND** running wheel / edge roller (SW6)



9.6. Fasten screw

9.7. Put device back on its rolls

9.8. In order to remove the running wheel / edge roller, perform the steps in reverse order

Fasten all screws and nuts !!!

SPARE PARTS DRAWINGS

Heating element and tube adapter

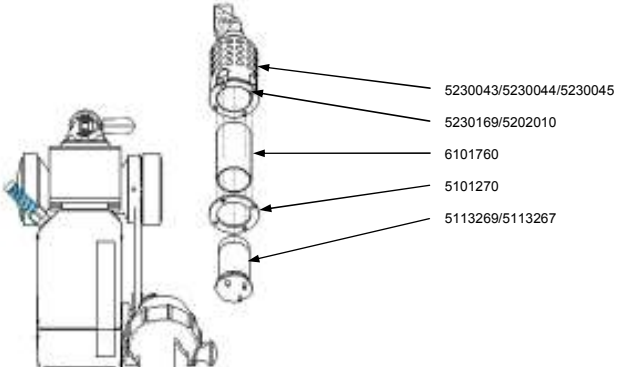

Lifting device

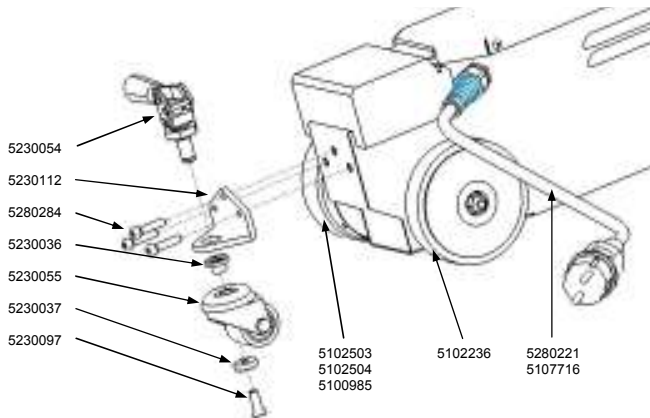

SPARE PARTS DRAWINGS

Guide rollers

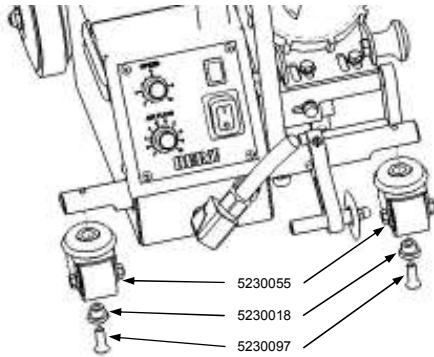



SPARE PARTS LIST

Art. no.	Description	Quantity (parts)
5230043	Overlap welding nozzle 20 mm	1
5230044	Overlap welding nozzle 30 mm	1
5230045	Overlap welding nozzle 40 mm	1
5202010	Rounded head screw M4x12, Torx	1
5230169	Rounded head screw M4x16, Torx	3
6101760	Mica tube Ø = 47, 6x95 mm	1
5101270	Heating element gasket	1
5113267	Heating element 120 V, 2600 W	1
5113269	Heating element 240 V, 3300 W	1
5230054	Push rod tightener for lifting device	1
5230112	Fastening angle for lifting device	1
5280284	Rounded head screw M5x20, Torx	3
5230036	Centring, push rod for lifting device	1
5230055	Guide roller	3
5230037	Centring disc, push rod for lifting device	1
5230018	Wheel centring for guide roller	3
5230097	Countersunk screw M6x20, Allen	3
5102503	Silicon rubber ring, pressure roller, 20 mm	1
5102504	Silicon rubber ring, pressure roller, 30 mm	1
5100985	Silicon rubber ring, pressure roller, 40 mm	1
5102236	Silicon rubber ring, drive roller	1
5280221	Power cable 3x1.5 mm ² with Schuko plug	1
5107716	Power cable 3x2.5 mm ² , 5 m with end sleeves (for 120 VAC version)	1

Deutsch		EG-Konformitätserklärung
HERZ-GmbH, A-6141 Schönberg/Austria, bestätigt, dass das nachfolgende Produkt in der von uns in Verkehr gebrachten Ausführung die Anforderung der folgenden Richtlinie(n) erfüllt.		
Bezeichnung des Gerätes : Schweissautomat Type : RoofOn Richtlinie(n) : EMV-Richtlinie 2004/108/EG; Niederspannungsrichtlinie 2006/95/EG; Maschinenrichtlinie 2006/42/EG		
Harmonisierte Normen : EN55014-1:2006+A1:2009; EN55014-2:1997 + Corrigendum:1997+A1:2001+A2:2008; EN61000-3-2:2006; EN61000-3-3:2006; EN61000-6-2:2005; EN61000-6-4:2007+A1:2011 EN60335-1:2012		Mag. Marion Herz-Degenkolb (Geschäftsführerin) Schönberg, 30.01.2011
Gelösch: 30		Gelösch: 7
English		Declaration of conformity
HERZ-GmbH, A-6141 Schönberg/Austria, confirms that this product, in the version as brought into circulation through us, fulfills the requirements of the following CEE directive(s).		
Description of tool : Welding machine Type : RoofOn Directives : EMC-Directive 2004/108/EG; Low-Voltage Directive 2006/95/EG; machinery Directive 2006/42/EG		
Harmonized standards : EN55014-1:2006+A1:2009; EN55014-2:1997 + Corrigendum:1997+A1:2001+A2:2008; EN61000-3-2:2006; EN61000-3-3:2006; EN61000-6-2:2005; EN61000-6-4:2007+A1:2011 EN60335-1:2012		Mag. Marion Herz-Degenkolb (Managing Director) Schönberg, 30.01.2011
Gelösch: 30		Gelösch: 30
Français		Déclaration CE de conformité
HERZ-GmbH, A-6141 Schönberg/Austria, confirme que ce produit correspond, en ce qui concerne la conception et le modèle type dans la version commercialisée par notre entreprise, aux réglementations figurant dans les directives européennes désignées ci-dessous.		
Description de l'appareil : Machine à souder Modèle : RoofOn Directives(s) : EMC-Directive 2004/108/EG; Directive de basse tension 2006/95/EG; directive Machines 2006/42/EG		
Normes Harmonisées : EN55014-1:2006+A1:2009; EN55014-2:1997 + Corrigendum:1997+A1:2001+A2:2008; EN61000-3-2:2006; EN61000-3-3:2006; EN61000-6-2:2005; EN61000-6-4:2007+A1:2011 EN60335-1:2012		Mag. Marion Herz-Degenkolb (Gérant) Schönberg, 30.01.2011
Gelösch: 30		Gelösch: 30
Español		Declaración CE de conformidad
HERZ-GmbH, A-6141 Schönberg/Austria, confirma, que este producto, conforme a la ejecución que comercializamos, cumple con las exigencias especificadas en las siguientes directivas de la CE.		
Denominación del aparato : Equipo de soldadura Modelo : RoofOn Directrice(s) : EMC-Directiva 2004/108/EG; Directiva de baja tensión 2006/95/EG; Directiva de Máquinas 2006/42/EG		
Normas armonizadas : EN55014-1:2006+A1:2009; EN55014-2:1997 + Corrigendum:1997+A1:2001+A2:2008; EN61000-3-2:2006; EN61000-3-3:2006; EN61000-6-2:2005; EN61000-6-4:2007+A1:2011 EN60335-1:2012		Mag. Marion Herz-Degenkolb (Gerente) Schönberg, 30.01.2011
Gelösch: 30		Gelösch: 7
Português		Declaração de conformidade
HERZ-GmbH, A-6141 Schönberg/Austria, confirma que este produto, deste modelo, posto em circulação por nós, cumpre as exigências das seguintes directivas CE.		
Descrição de instrumento : Máquina de solda Datilografar : RoofOn Directiva(s) : EMC-Directiva 2004/108/EG; Directiva de baixa tensão 2006/95/EG; Directiva máquinas 2006/42/EG		
Normas conciliadas : EN55014-1:2006+A1:2009; EN55014-2:1997 + Corrigendum:1997+A1:2001+A2:2008; EN61000-3-2:2006; EN61000-3-3:2006; EN61000-6-2:2005; EN61000-6-4:2007+A1:2011 EN60335-1:2012		Mag. Marion Herz-Degenkolb (Diretor-gerente) Schönberg, 30.01.2011
Gelösch: 30		Gelösch: 30
Italiano		Dichiarazione CE di conformità
HERZ-GmbH, A-6141 Schönberg/Austria, conferma che questo prodotto da noi introdotto sul mercato soddisfa tutti i requisiti richiesti dalle seguenti direttive della CE.		
Descrizione dell'apparecchio : Saldatrice Modello : RoofOn Direttive : Direttiva antisturbo/EMC 2004/108/EG; Direttiva bassa tensione 2006/95/EG; direttiva Macchine 2006/42/EG		
Norme armonizzate : EN55014-1:2006+A1:2009; EN55014-2:1997 + Corrigendum:1997+A1:2001+A2:2008; EN61000-3-2:2006; EN61000-3-3:2006; EN61000-6-2:2005; EN61000-6-4:2007+A1:2011 EN60335-1:2012		Mag. Marion Herz-Degenkolb (Direttore Generale) Schönberg, 30.01.2011
Gelösch: 7		Gelösch: 7
Nederland		Conformiteitsverklaring
HERZ-GmbH, A-6141 Schönberg/Austria, bevestigt dat dit product in de door ons in omloop gebrachte uitvoering voldoet aan de eisen van de volgende EG-richtlijnen.		
Beschrijving van het instrument : Lasmachine Typen : RoofOn Instructie : EMC-richtlijn 2004/108/EG; Low-voltage richtlijn 2006/95/EG; Machinerichtlijn 2006/42/EG		
Geharmoniseerde normen : EN55014-1:2006+A1:2009; EN55014-2:1997 + Corrigendum:1997+A1:2001+A2:2008; EN61000-3-2:2006; EN61000-3-3:2006; EN61000-6-2:2005; EN61000-6-4:2007+A1:2011 EN60335-1:2012		Mag. Marion Herz-Degenkolb (Directeur) Schönberg, 30.01.2011
Gelösch: 30		Gelösch: 30
Slovensky		Deklaracija o ustreznosti
HERZ-GmbH, A-6141 Schönberg/Austria, potrjuje, da ta izdelek v izvedbi, ki jo prodajamo, izpolnjuje zahteve naslednjih smernic EG.		
Opis naprave: : Varjenje Tip : RoofOn Smernice : Smernica o elektromagnetni združljivosti 2004/108/ES; Smernica o nizki napetosti 2006/95/ES; Direktiva o strojih 2006/42/ES		
Usklajeni normativi : EN55014-1:2006+A1:2009; EN55014-2:1997 + Corrigendum:1997+A1:2001+A2:2008; EN61000-3-2:2006; EN61000-3-3:2006; EN61000-6-2:2005; EN61000-6-4:2007+A1:2011 EN60335-1:2012		Mag. Marion Herz-Degenkolb (poslovođa) Schönberg, 30.01.2011
Gelösch: 30		Gelösch: 30

Română		Declaratia de conformitate
HERZ-GmbH, A-6141 Schönberg/Austria, confirmă că, acest produs, în varianta de execuție prezentată de noi, satisface cerințele următoarelor Directive CE. Descrierea unealta : Sudarea magină Tipul : Roof/On Directive : EMC-Directiva 2004/108/EG; Directiva low-voltage 2006/95/EG; Masini de Directiva 2006/42/EG		Mag. Marion Herz-Degenkolb (Directorul general al Schönberg, 30.01.2011
Norme armonizate : EN55014-1:2006+A1:2009; EN55014-2:1997 + Corrigendum:1997+A1:2001+A2:2008; EN61000-3-2:2006; EN61000-3-3:2008; EN61000-6-2:2005; EN61000-6-4:2007+A1:2011 EN60335-1:2012		Gelöscht: . Gelöscht: . Gelöscht: 30
Slovensko		Prehľadanie o shode
HERZ-GmbH, A-6141 Schönberg/Austria, potvrdzuje, že tento výrobok vo vyhotovení, ktoré dávame do predaja, zodpovedá požiadavkám nasledovných smerníc ES. Označenie prístroja : Zváracka Typ : Roof/On Smernice : EMV-Smernice 2004/108/EG; NN-Smernice 2006/95/EG; Masini de Directiva 2006/42/EG		Mag. Marion Herz-Degenkolb (Konateľ) Schönberg, 30.01.2011
Harmonizované normy : EN55014-1:2006+A1:2009; EN55014-2:1997 + Corrigendum:1997+A1:2001+A2:2008; EN61000-3-2:2006; EN61000-3-3:2008; EN61000-6-2:2005; EN61000-6-4:2007+A1:2011 EN60335-1:2012		Gelöscht: . Gelöscht: . Gelöscht: 30
Lietuvių		Atitikties deklaracija
HERZ-GmbH, A-6141 Schönberg/Austria, mes patvirtiname, kad šio produkto modelis, paleistas į ppyvartą , pilnutina atitinka sekancias EB direktyvas. Irankio aprašymas : Suvirinimo įrenginias Tipas : Roof/On Direktyvos : EMS direktyva 2004/108/EB; žemų įtamptų direktyva 2006/95/EB; Masinu direktyva 2006/42/EB		Mag. Marion Herz-Degenkolb (monės vadovas) Schönberg, 30.01.2011
Harmonizuotos normos : EN55014-1:2006+A1:2009; EN55014-2:1997 + Corrigendum:1997+A1:2001+A2:2008; EN61000-3-2:2006; EN61000-3-3:2008; EN61000-6-2:2005; EN61000-6-4:2007+A1:2011 EN60335-1:2012		Gelöscht: . Gelöscht: . Gelöscht: 30
Latviešu		Atbilstības deklarācija
HERZ-GmbH, A-6141 Schönberg/Austria, apliecina, ka šis mūsu apgrozījumā nodotais modeļa izstrādājums atbilst visām sekojošajām EB direktīvu prasībām. Instrumenta apraksts : Metinšanas iekārta Tips : Roof/On Direktīvas : EMC direktīva 2004/108/EG; Zemsprieguma direktīva 2006/95/EG; Masīnu direktīva 2006/42/EG		Mag. Marion Herz-Degenkolb (Ģenerāldirektors) Schönberg, 30.01.2011
Harmonizētas normas : EN55014-1:2006+A1:2009; EN55014-2:1997 + Corrigendum:1997+A1:2001+A2:2008; EN61000-3-2:2006; EN61000-3-3:2008; EN61000-6-2:2005; EN61000-6-4:2007+A1:2011 EN60335-1:2012		Gelöscht: . Gelöscht: 30
Dansk		Conformiteitsverklaring
HERZ-GmbH, A-6141 Schönberg/Austria, bekræfter, at dette produkt i den af os kedsforte udfærelse overensstemmelse med kravene i følgende EF-direktiver. Beskrivning van het instrument : Svejsemaskine Typen : Roof/On Instructie : EMC-richtlijn 2004/108/EG; Low-voltage richtlijn 2006/95/EG; Maskindirektiv 2006/42/EG		Mag. Marion Herz-Degenkolb (Director) Schönberg, 30.01.2011
Geharmoniseerde normen : EN55014-1:2006+A1:2009; EN55014-2:1997 + Corrigendum:1997+A1:2001+A2:2008; EN61000-3-2:2006; EN61000-3-3:2008; EN61000-6-2:2005; EN61000-6-4:2007+A1:2011 EN60335-1:2012		Gelöscht: . Gelöscht: . Gelöscht: 30 Gelöscht: 7
Svenska		Försäkran om överensstämmelse
HERZ-GmbH, A-6141 Schönberg/Austria, försäkrar att denna produkt i det utförande vi har levererat produkten överensstämmer med kraven i följande EF-direktiv. Beskrivning av verktyg : Svejsmaskin Typ : Roof/On Direktion : EMC-direktiv 2004/108/EG; Låg-Spänning direktiv 2006/95/EG; Maskindirektiv 2006/42/EG		Mag. Marion Herz-Degenkolb (Direktör) Schönberg, 30.01.2011
Harmoniserade standarder : EN55014-1:2006+A1:2009; EN55014-2:1997 + Corrigendum:1997+A1:2001+A2:2008; EN61000-3-2:2006; EN61000-3-3:2008; EN61000-6-2:2005; EN61000-6-4:2007+A1:2011 EN60335-1:2012		Gelöscht: . Gelöscht: 30
Suomi		Vaatimustenmukaisuusvakuutus
HERZ-GmbH, A-6141 Schönberg/Austria, todistaa, että tämä tuote, meiltä toimittamassamme kuossaa läytää seuraavien EY-direktiivien vaatimukset Tuotteen kuvaus : Hitsauskone Type : Roof/On Direktiivit : EMC-direktiivi 2004/108/EG; Pienjännitedirektiivi 2006/95/EG; Masīnu direktīva 2006/42/EG		Mag. Marion Herz-Degenkolb (Toimitusjohtaja) Schönberg, 30.01.2011
Harmonisoituid standardit : EN55014-1:2006+A1:2009; EN55014-2:1997 + Corrigendum:1997+A1:2001+A2:2008; EN61000-3-2:2006; EN61000-3-3:2008; EN61000-6-2:2005; EN61000-6-4:2007+A1:2011 EN60335-1:2012		Gelöscht: . Gelöscht: 30 Gelöscht: 7
Ελληνική		Δήλωση της πιστότητας
HERZ-GmbH, A-6141 Schönberg/Austria, επιβεβαιώνει ότι το προϊόν, με τη μορφή που τίθενται σε κυκλοφορία με εμάς, πληροί τις απαιτήσεις των παρακάτω CEE οδηγιών(ες). Περιγραφή του νομοθετικού μέσου : Ηλεκτροσυγκόλληση θερμού αέρα εργαλείο Οδηγίες : EMC-οδηγία 2004/108/EG; Χαμηλής Τάσης οδηγίες 2006/95/EG; οδηγία για τα Μηνύματα 2006/42/EG		Mag. Marion Herz-Degenkolb (Γενικό Διευθυντή) Schönberg, 30.01.2011
εναρμονιζώ πρότυπα : EN55014-2:1997 + Corrigendum:1997+A1:2001+A2:2008; EN55014-1:2006+A1:2009; EN61000-3-2:2006; EN61000-3-3:2008; EN61000-6-2:2005; EN61000-6-4:2007+A1:2011EN60335-1:2012		Gelöscht: . Gelöscht: 30 Gelöscht: 7 Gelöscht: 30 Gelöscht: 7

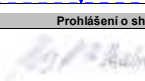
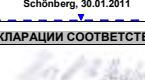
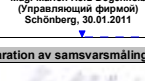
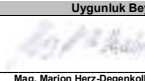
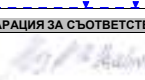
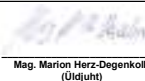
Polski		Deklaracja zgodności CE	
HERZ-GmbH, A-6141 Schönberg/Austria, poświadczam, że produkt w tym wykonaniu handlowym spełnia wymogi następujących dyrektyw UE: Opis urządzenia : Urządzenia spawalnicze Typ : RoofOn Dyrektywy : EMC-Dyrektywa 2004/108/EG; niskonapięciowa dyrektywa 2006/95/EG; Dyrektywa maszynowa 2006/42/EG		 Mag. Marion Herz-Degenkolb (Właściciel) Schönberg, 30.01.2011	
Zharmonizowane normy : EN55014-1:2006+A1:2009; EN55014-2:1997 + Corrigendum:1997+A1:2001+A2:2008; EN61000-3-2:2006; EN61000-3-3:2008; EN61000-6-2:2005; EN61000-6-4:2007+A1:2011 EN60335-1:2012			
Magyar		CE – Gyártói nyilatkozat	
HERZ-GmbH, A-6141 Schönberg/Austria igazolja, hogy ez a termék az általam forgalomba hozott kivitelben megfelel az alábbi irányelvek követelményeinek. Készülék fajta : Hegesztőgép Tipus : RoofOn Irányelvek : EMC-irányelv: 2004/108/EG; Alacsonyfeszültségű irányelv: 2006/95/EG; Gépekről szóló irányelv 2006/42/EG		 Mag. Marion Herz-Degenkolb (Gyártó) Schönberg, 2008.12.05.	
Harmonizált szabványok : EN55014-1:2006+A1:2009; EN55014-2:1997 + Corrigendum:1997+A1:2001+A2:2008; EN61000-3-2:2006; EN61000-3-3:2008; EN61000-6-2:2005; EN61000-6-4:2007+A1:2011 EN60335-1:2012			
Česky		Prohlášení o shodě	
HERZ-GmbH, A-6141 Schönberg/Austria, potvrzuje, že tento výrobek v provedení daném námi do provozu splňuje požadavky následujících směrnic EU Označení výrobku : Svářeč Typ : RoofOn Směrnice : EMC-směrnice 2004/108/EG; Low-Voltage směrnice 2006/95/EG; Směrnice pro strojní zařízení 2006/42/EG		 Mag. Marion Herz-Degenkolb (Jednatel) Schönberg, 30.01.2011	
Harmonizované normy : EN55014-1:2006+A1:2009; EN55014-2:1997 + Corrigendum:1997+A1:2001+A2:2008; EN61000-3-2:2006; EN61000-3-3:2008; EN61000-6-2:2005; EN61000-6-4:2007+A1:2011 EN60335-1:2012			
Русский язык		CE - ЗАЯВЛЕНИЕ О ДЕКЛАРАЦИИ СООТВЕТСТВИЯ	
HERZ-GmbH, A-6141 Schönberg/Austria, подтверждает, что нижеуказанный продукт в нами принятым в торговый оборот исполнении выполняет требования следующей(их) директива(й). Описание прибора : Сварочный аппарат Тип : RoofOn Директива : ЭМС-директива 2004/108/EG; директива низкого напряжения 2006/95/EG; Директива по машинному оборудованию 2006/42/EG		 Mag. Marion Herz-Degenkolb (Управляющий фирмой)	
Согласованные нормы : EN55014-1:2006+A1:2009; EN55014-2:1997 + Corrigendum:1997+A1:2001+A2:2008; EN61000-3-2:2006; EN61000-3-3:2008; EN61000-6-2:2005; EN61000-6-4:2007+A1:2011 EN60335-1:2012			
Norsk		Deklarasjon av samsvarsmåling fra	
HERZ-GmbH, A-6141 Schönberg, bekrefter at denne modellen av vårt selte produkt oppfyller kravene i følgende EF-direktiver: Beskrivelse av verktøyet : Sveiseapparat Typ : RoofOn Direktivene : EMC-direktiv 2004/108/EG; Lav-Volt direktivet 2006/95/EG; Maskindirektiv 2006/42/EG		 Mag. Marion Herz-Degenkolb (General Manager) Schönberg, 30.01.2011	
Harmoniserte standarder : EN55014-1:2006+A1:2009; EN55014-2:1997 + Corrigendum:1997+A1:2001+A2:2008; EN61000-3-2:2006; EN61000-3-3:2008; EN61000-6-2:2005; EN61000-6-4:2007+A1:2011 EN60335-1:2012			
Türkçe		Uygunluk Beyanı	
HERZ-GmbH, A-6141 Schönberg, bu ürünün piyasaya sunduğumuz halindeki uygunsuzluk beyanı eder. Açıklama takım : Hava ıstıcı Tip : RoofOn Yönetmelikler : EMC – Directive 2004/108/EG; Düşük - Gerilim Direktif 2006/95/EG; Makine Direktif 2006/42/EG		 Mag. Marion Herz-Degenkolb (General Manager) Schönberg, 30.01.2011	
Birleşik normlar : EN55014-1:2006+A1:2009; EN55014-2:1997 + Corrigendum:1997+A1:2001+A2:2008; EN61000-3-2:2006; EN61000-3-3:2008; EN61000-6-2:2005; EN61000-6-4:2007+A1:2011 EN60335-1:2012			
Български		CE - ДЕКЛАРАЦИЯ ЗА СЪОТВЕТСТВИЕ	
ХЕРЗ-ГМБХ, А-6141 Шьонберг/Австрия, потвърждава, че следният продукт, във варианта разпространяван от нас, изпълнява изискванията на следните нормативи(и). Наименование на уреда : Сваръчен апарат Тип : RoofOn Норматив(и) : EMC-норматив 2004/108/EG; Норматив за ниско напрежение 2006/95/EG; Масинен директив 2006/42/EG		 Mag. Marion Herz-Degenkolb (Управител) Schönberg, 30.01.2011	
Хармонизирани норми : EN55014-1:2006+A1:2009; EN55014-2:1997 + Corrigendum:1997+A1:2001+A2:2008; EN61000-3-2:2006; EN61000-3-3:2008; EN61000-6-2:2005; EN61000-6-4:2007+A1:2011 EN60335-1:2012			
Eesti		Vastavusdeklaratsioon	
HERZ-GmbH, A-6141 Schönberg/Austria, kinnitab, et see toode täidab meie poolt ringluse toodud kujul järgmist EU-direktiivide nõudeid. Tööriista nimetus : Keevitus masin Mudel : RoofOn Direktiivid : EMC-direktiiv 2004/108/EG; Madalpingedirektiiv 2006/95/EG; Masinadirektiiv 2006/42/EG		 Mag. Marion Herz-Degenkolb (Üldjuht) Schönberg, 30.01.2011	
Harmoniseeritud normid : EN55014-1:2006+A1:2009; EN55014-2:1997 + Corrigendum:1997+A1:2001+A2:2008; EN61000-3-2:2006; EN61000-3-3:2008; EN61000-6-2:2005; EN61000-6-4:2007+A1:2011 EN60335-1:2012			

Gelöschit: .

Gelöschit: 30

Gelöschit: .

Gelöschit: .

Gelöschit: 30

Gelöschit: .

Gelöschit: .

Gelöschit: 30

Gelöschit: 30

Gelöschit: .

Gelöschit: .

Gelöschit: 30

Gelöschit: 7

Gelöschit: .

Gelöschit: .

Gelöschit: 30

Gelöschit: 7

Gelöschit: .

Gelöschit: .

Gelöschit: .

Gelöschit: 30

