

*Bar of Firestop Putty
Included in kit

Parts Included (Not to Scale)

New Work Installations

1

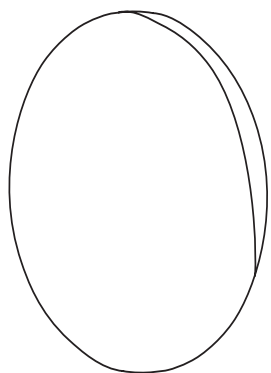

Create round opening in assembly.

2

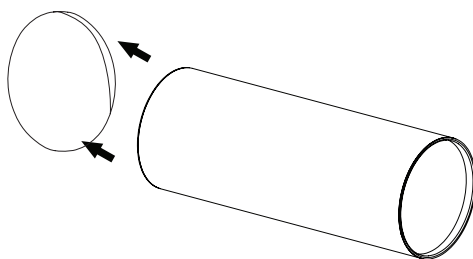

Place sleeve in opening.

3

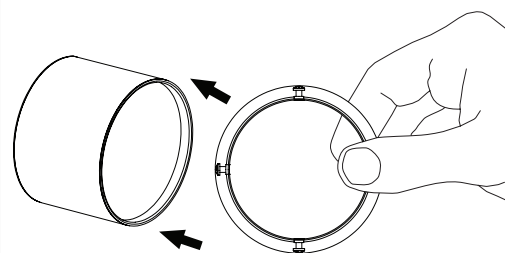

Install 1 flange and gasket onto sleeve.

4

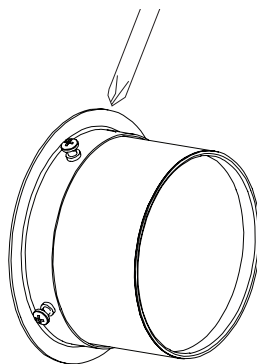

With escutcheon plates held tightly against wall, tighten screws. Repeat process on other side of wall.

5

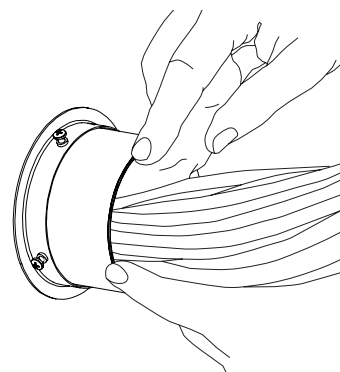

After cabling is installed, install SpecSeal® Putty into sleeve on each side of assembly, flush with ends of steel sleeve. See appropriate UL System for more detail.

TABLE 1

Catalog Number	Trade Size	Minimum Opening Size	Maximum Opening Size
FS100	1" (25 mm)	1.163" (30 mm)	1.25" (32 mm)
FS200, FS201	2" (51mm)	2.375" (60 mm)	2.5" (65 mm)
FS400, FS401	4" (102 mm)	4.500" (114 mm)	4.5" (114 mm)

